

AUCTION

OFFERING: 314 Acres in Dickey County, ND

Auction Location: Oakes Community Center in Oakes, ND

Tuesday, October 15th, 2024 at 1 PM CT

Sellers: Arlene Meehl Estate

PARCEL #1: SE4 of Sec. 24-132-60

Total Acres: 158

Land Location: From Oakes, ND - 4 mi N on Hwy 1 then 2 mi W on 83rd St SE & 2 mi N on 108th Ave SE

Tillable Acres: 152.12 acres or 96%

Soil P.I.N.: 72.27

PARCEL #2: NE4 of Sec. 25-132-59

(Less 4.01 acres)

Total Acres: 155.99

Land Location: From Oakes, ND - 6 mi N on Hwy 1 & 3.5 mi E on Hwy 13

Tillable Acres: 142.06 acres or 77%

Soil P.I.N.: 76

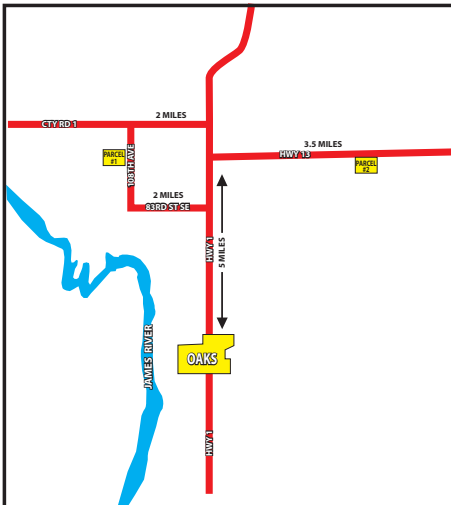

AUCTIONEERS NOTE: Both parcels offer very good access. They've been well-managed and have fertile soil. The 2024 seasons has produced bumper crop of corn & soybeans.

The Meehl land auction is being conducted by Awender Auction Co. & Wolff Auctioneers.

WOLFF
AUCTIONEERS

Shane Wolff (701) 870-9090
wolffauctioneers.com



Awender Auction
& Clerking Service

Pete Awender (701)742-2456
colpete@awenderauction.com